

COLLEGE

Planning & Management

FACILITIES • SECURITY • TECHNOLOGY • BUSINESS

July 2013 / webCPM.com

Rebuild or Renovate?

Historic Facilities on Today's Campus

MANAGING TROUBLED STUDENTS

TAKE A TEAM APPROACH
TO IDENTIFY AND
SOLVE PROBLEMS

LIVING AND LEARNING

TRENDS IN RESIDENCE
HALL DESIGN, DÉCOR AND
PROGRAMMING

SPECIAL SECTION

THE SAFER CAMPUS



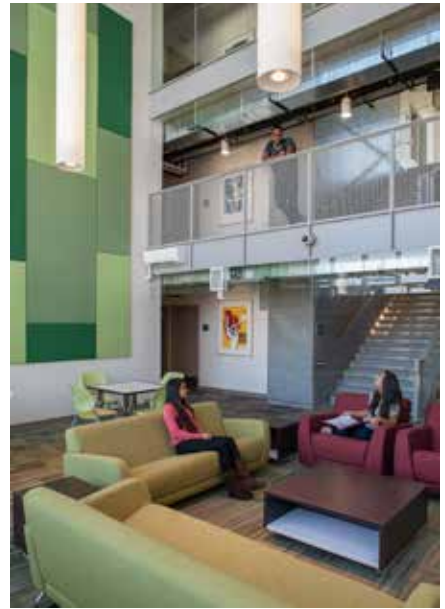

PHOTOS © PETER ECKERT, ECKERT AND ECKERT PHOTOGRAPHY



Portland State University

University Pointe at College Station

IN THE FALL OF 2012, PORTLAND State University (PSU) and American Campus Communities (ACC) opened University Pointe at College Station, a remarkable student housing community in one of America's most progressive cities. Designed by Portland-based firm SERA Architects and built by Walsh Construction Co., the 16-story, 371,000-square-foot high-rise offers 282 units comprised of studios and apartments with private and shared accommodations, as well as academic classroom spaces and a lecture hall. The new building is a model of mixed-use urban living and houses nearly 1,000 PSU students, making it currently the most densely populated block in Oregon. With light-rail train stations on two sides,

University Pointe at College Station exemplifies successful transit-oriented development.

The building's first floor combines retail and academic space with community amenities including a fitness center, social and study areas, mailroom, large outdoor courtyard and two light rail stops. "ACC's senior vice president of On-Campus Development, Jason Wills, was concerned that students can feel isolated in high-rise dormitory settings. From the project's beginning, Jason challenged our design team to create a strong sense of community that would encourage residents to interact," says Kurt Schultz, principal, SERA Architects. To achieve vibrant internal communities, the 15 residential stories were divided into five social blocks of three-story

neighborhoods. Each neighborhood has a three-story vertical community space featuring a social lounge, laundry facility, communicating stair and study rooms with stunning views of Portland. Express elevators serve each neighborhood community space only. This design relieves vertical elevator traffic and promotes interaction in the neighborhood's common areas and communicating stair.

The LEED Gold-certified building showcases green development practices as part of educating students for the future. From energy-efficient systems and operable ventilation, to green roofs and disposal capture, students see and experience a smaller carbon footprint lifestyle with a high-quality design and construction. [CPM](#)